

# For International ICT Expo ONLY

## Premium Booth 3mW x 3mD One side open

SD-C-9  
3mW x 3mD x 3.5mH

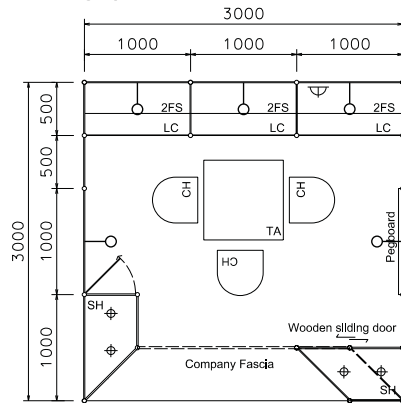

PLAN

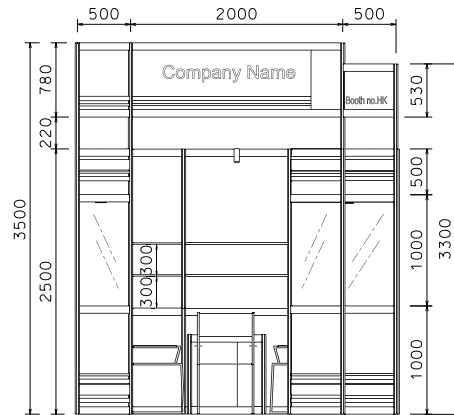

FRONT ELEVATION

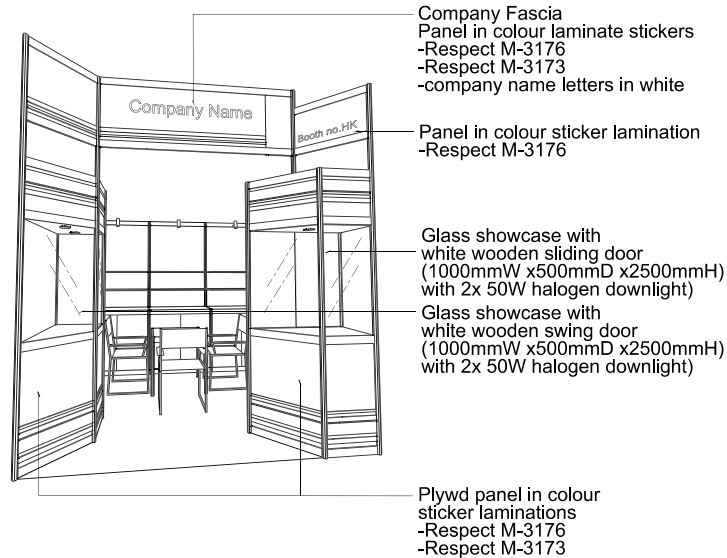

PERSPECTIVE N.T.S



COLOUR PERSPECTIVE N.T.S

BOOTH SPECIFICATION		QTY
	Front glass showcase in sticker lamination with white wooden swing door. 2 x (50W) halogen downlight (1m W x 0.5mD x 2.5m H)	1
	Front glass showcase in sticker lamination with white wooden sliding doors. 2 x (50W) halogen downlight (1m W x 0.5mD x 2.5m H)	1
	Lockable cabinet (1mL x 0.5mD x 1mH)	3
	Wooden shelf (flat) (1mL x 0.3mD)	6
	Pegboard with 30 hooks (1mW x 2.5mH)	1
	Square meeting table (0.7m X 0.7m x 0.75mH)	1
	Black leather chair	3
	Longarmed spotlight w/23 watt energy saving lamp (yellow)	5
	500w Square pin power socket	1

FILE PATH - L:\Local Fair Premium Booth 2011\ICT\SD-C layout\SD-C-2d\layout\_update.dgn



NOTES UNLESS OTHERWISE SPECIFIED ALL DIMENSIONS ARE IN MM.

.....  
.....  
.....

REVISION

DATE: 18/09/2014  
SCALE: 1 : 50 (A3)  
DRAWN BY: ..  
CHECKED BY: .....

TITLE

Premium Booth SD-C-9

PROJECT

ICT PREMIUM BOOTH 3m x 3m

DATE: XXXXXXXX

SHEET

SD-C01

# For International ICT Expo ONLY

## Premium Booth 3mW x 3mD Left Corner booth

SD-C-9-L\_Cnr  
3mW x 3mD x 3.5mH

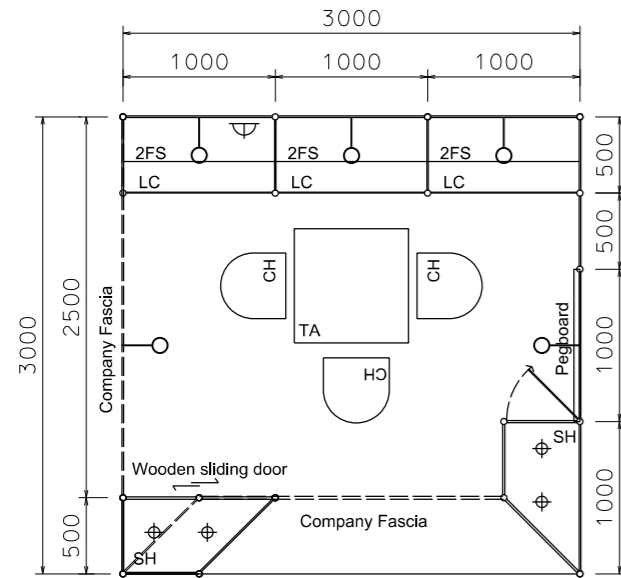

PLAN

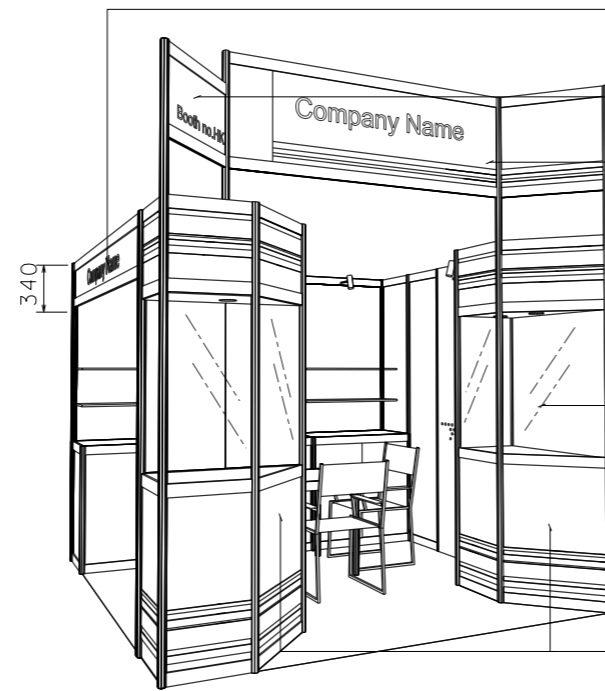

PERSPECTIVE N.T.S

Fascia background in blue colour sticker lamination (Respect M-3173)  
company name letter in white

Panel in colour sticker lamination  
-Respect M-3176

Company Fascia  
2000mmW x 700mm H  
Panel in colour laminate stickers  
-Respect M-3176  
-Respect M-3173  
-company name in white letter

Glass showcase with white wooden sliding door  
(1000mmW x 500mmD x 2500mmH)  
with 2x 50W halogen downlight

Plywd panel in colour sticker laminations  
-Respect M-3176  
-Respect M-3173



COLOUR PERSPECTIVE N.T.S

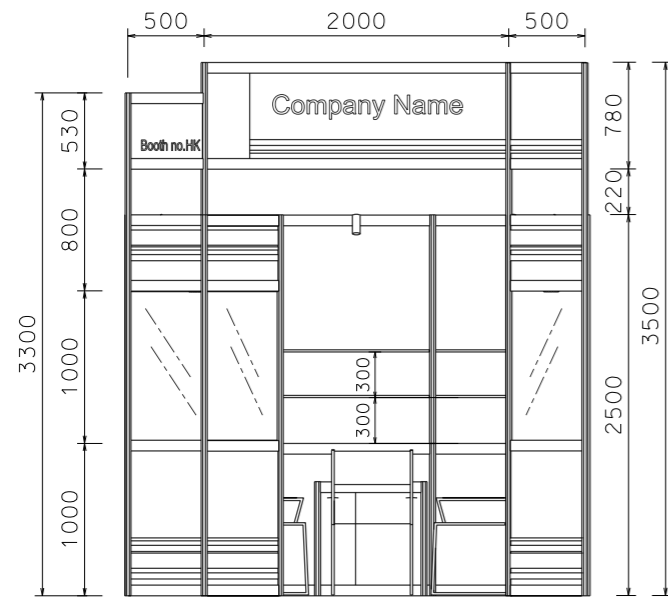

FRONT ELEVATION

BOOTH SPECIFICATION		QTY
	Front glass showcase in sticker lamination with white wooden swing door. 2 x (50W) halogen downlight (1m W x 0.5mD x 2.5m H)	1
	Front glass showcase in sticker lamination with white wooden sliding doors. 2 x (50W) halogen downlight (1m W x 0.5mD x 2.5m H)	1
	Lockable cabinet (1mL x 0.5mD x 1mH)	3
	Wooden shelf (flat) (1mL x 0.3mD)	6
	Pegboard with 30 hooks (1mW x 2.5mH)	1
	Square meeting table (0.7m X0.7m x 0.75mH)	1
	Black leather chair	3
	Longarmed spotlight w/23 watt energy saving lamp (yellow)	5
	500w Square pin power socket	1

FILE PATH - L:\Local Fair Premium Booth 2011\ICT\SD-C layout\SD-C-2d\layout\_update.dgn



25/9/2014 10:10:15

NOTES	UNLESS OTHERWISE SPECIFIED ALL DIMENSIONS ARE IN MM.
.....	.....
.....	.....
.....	.....

REVISION
.....

DATE:	18/09/2014
SCALE:	1 : 50 (A3)
DRAWN BY:	..
CHECKED BY:	.....

TITLE	Premium Booth SD-C-9 L-Corner
-------	-------------------------------

PROJECT	PREMIUM BOOTH 3m x 3m Corner
DATE:	XXXXXXXX

SHEET	SD-C01b
-------	---------

# For International ICT Expo ONLY

## Premium Booth 3mW x 3mD Right Corner booth

SD-C-9-R Cnr  
3mW x 3mD x 3.5mH

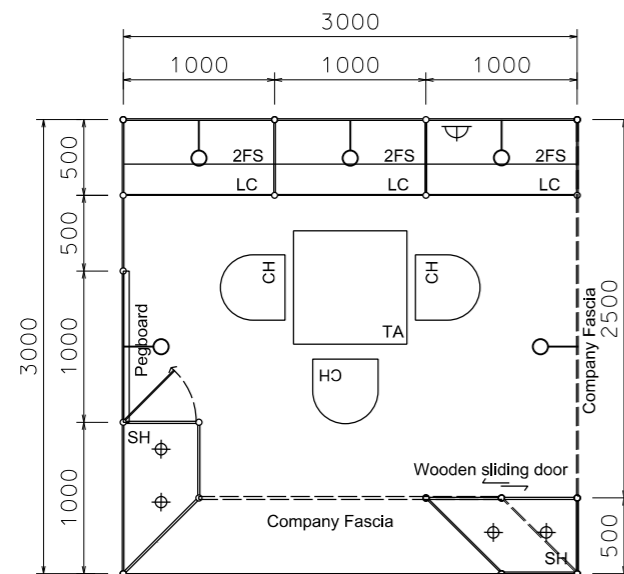

PLAN

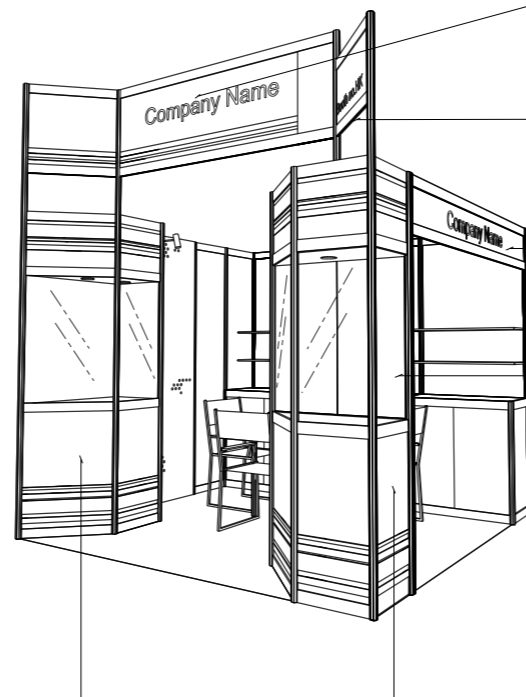

PERSPECTIVE N.T.S.

- Company Fascia  
2000mmW x 700mm H  
Panel in colour laminate stickers  
-Respect M-3176  
-Respect M-3173  
-company name letter in white
- Panel in colour sticker lamination  
-Respect M-3176
- Fascia background in blue colour sticker lamination (Respect M-3173)  
company name letter in white
- Glass showcase with white wooden sliding door (1000mmW x500mmD x2500mmH) with 2x 50W halogen downlight)
- Plywd panel in colour sticker laminations  
- Respect M-3176  
- Respect M-3173

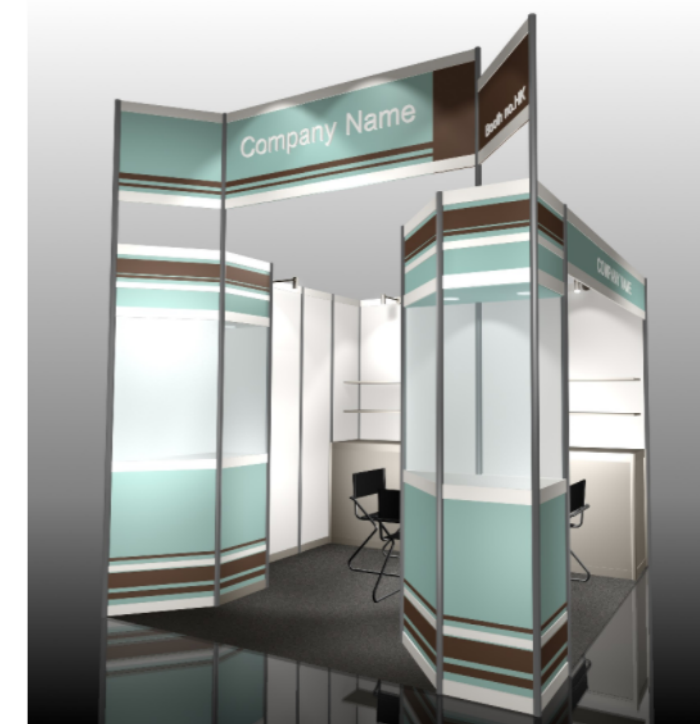

COLOUR PERSPECTIVE N.T.S.

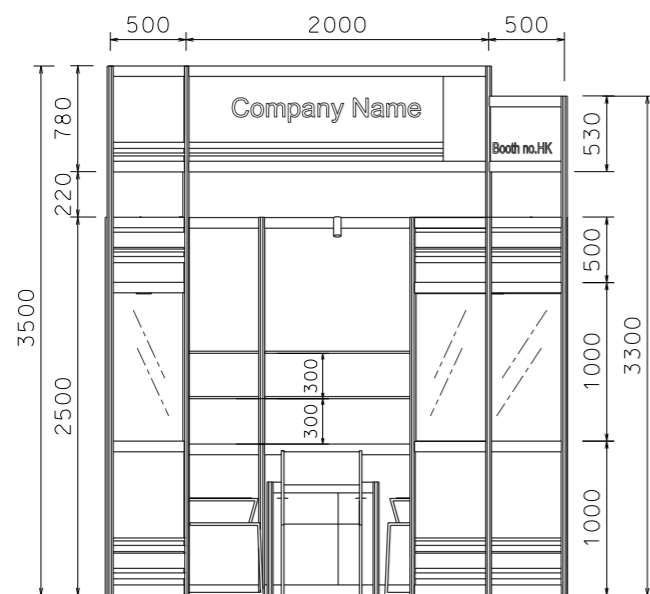

FRONT ELEVATION

BOOTH SPECIFICATION		QTY
	Front glass showcase in sticker lamination with white wooden swing door. 2 x (50W) halogen downlight (1m W x 0.5mD x 2.5m H)	1
	Front glass showcase in sticker lamination with white wooden sliding doors. 2 x (50W) halogen downlight (1m W x 0.5mD x 2.5m H)	1
	Lockable cabinet (1mL x 0.5mD x 1mH)	3
	Wooden shelf (flat) (1mL x 0.3mD)	6
	Pegboard with 30 hooks (1mW x 2.5mH)	1
	Square meeting table (0.7m X0.7m x 0.75mH)	1
	Black leather chair	3
	Longarmed spotlight w/23 watt energy saving lamp (yellow)	5
	500w Square pin power socket	1

FILE PATH - L:\Local Fair Premium Booth 2011\ICT\SD-C layout\SD-C-2d\Layout\_update.dgn



NOTES UNLESS OTHERWISE SPECIFIED ALL DIMENSIONS ARE IN MM.

.....  
.....  
.....

.....  
.....  
.....

REVISION

DATE: 18/09/2014

SCALE: 1 : 50 (A3)

DRAWN BY: ..

CHECKED BY: .....

TITLE

Premium Booth SD-C-9 R-Corner

PROJECT

PREMIUM BOOTH 3m x 3m Corner

DATE: XXXXXXXX

SHEET

SD-C01a