

For International ICT ONLY

Premium Booth 4mW x 3mD Left corner booth

SD-A-12-L_Cnr
4mW x 3mD x 3.5mH

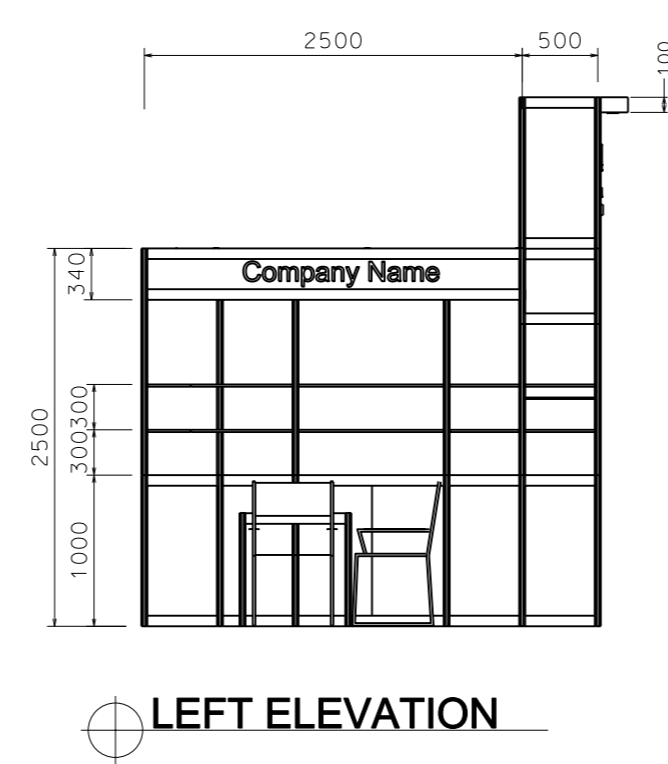
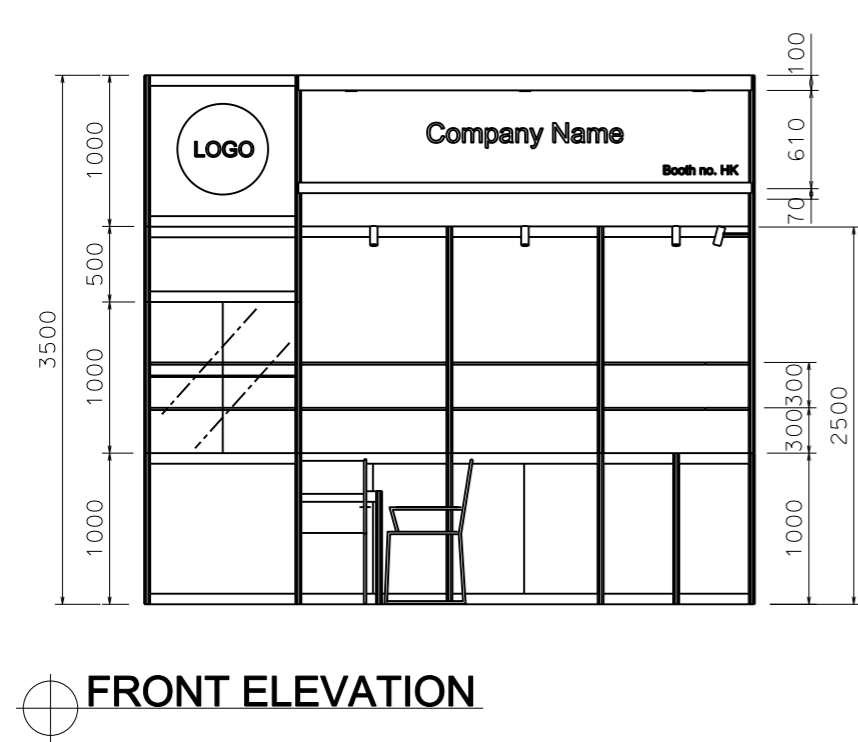
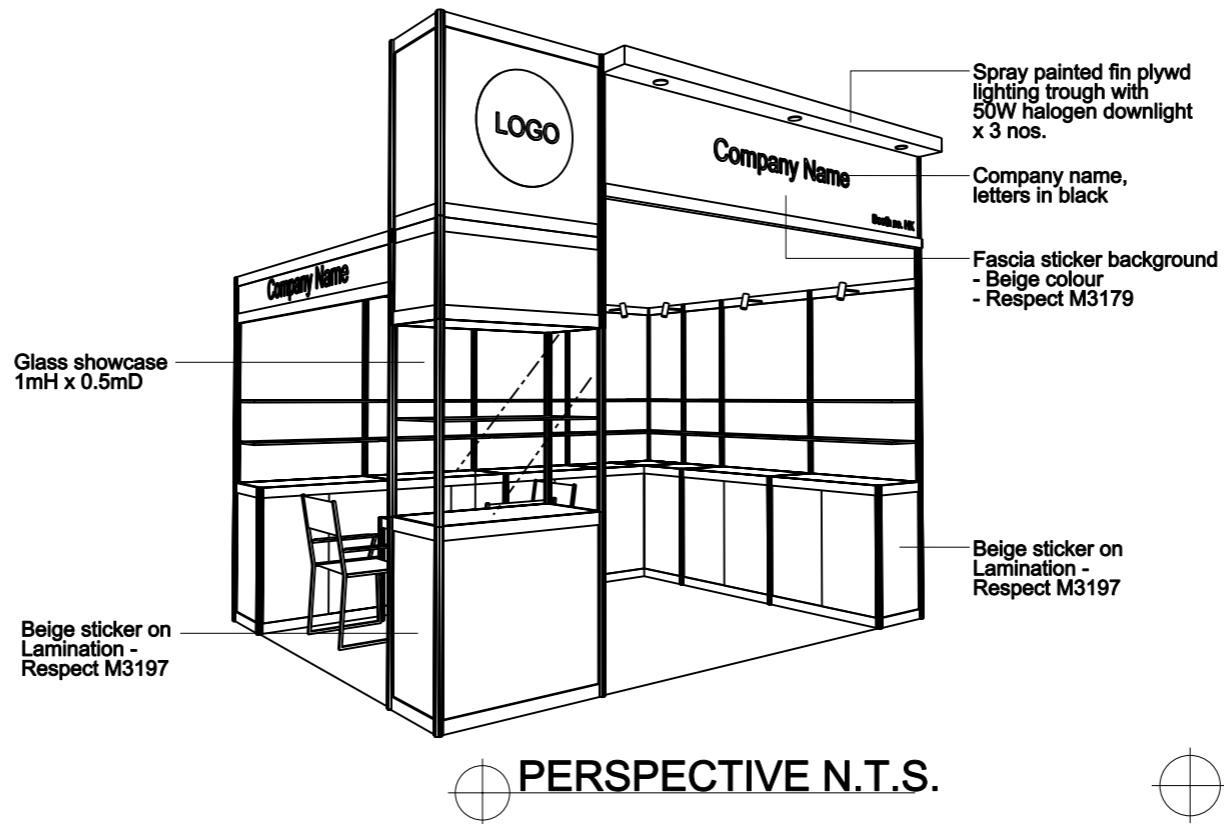
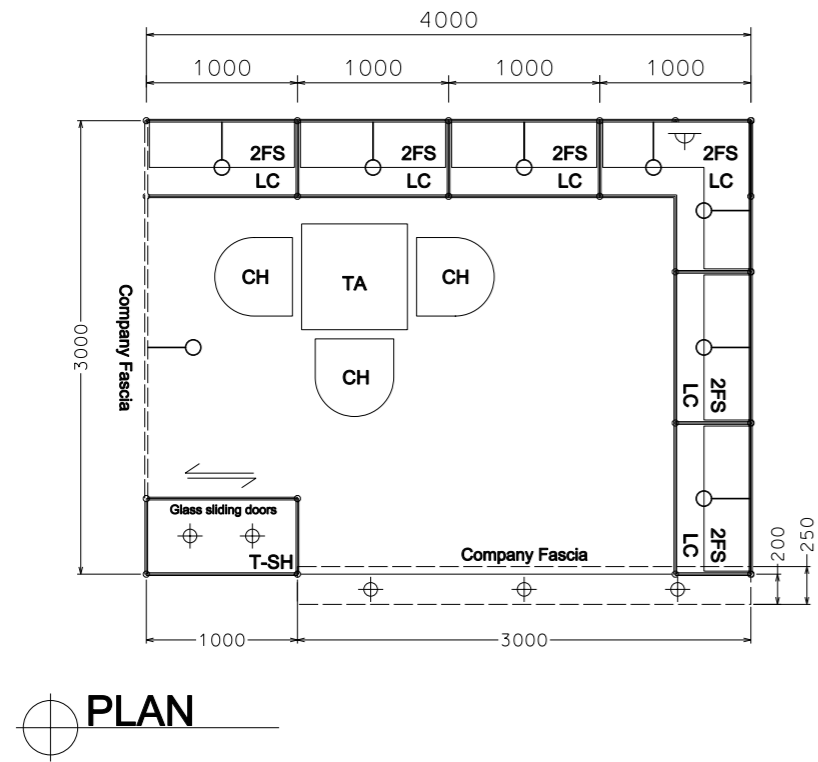

BOOTH SPECIFICATION		QTY
	Tall showcase in beige sticker lamination, 1 layer of glass shelf, 2x 50W halogen downlights	1
	Lockable cabinet in beige sticker lamination (1mL x 0.5mD x 1mH)	6.5
	Wooden shelf (flat) (1mL x 0.3mD)	14
	Square meeting table (0.7m X0.7m x 0.75mH)	1
	Black leather chair	3
	Longarmed spotlight w/23 watt energy saving lamp (yellow)	8
	50W Halogen light (for fascia)	3
	500w Square pin power socket	1
	Company Logo	1

FILE PATH - L:\Local Fair Premium Booth 2011\ICT\SD-A layout\SD-A-Layout_Cnr_update.dgn



NOTES UNLESS OTHERWISE SPECIFIED ALL DIMENSIONS ARE IN MM.

.....
.....
.....

REVISION

DATE: 12/09/2014
SCALE: 1 : 50 (A3)
DRAWN BY: ..
CHECKED BY:

TITLE

Premium Booth
SD-A-12-L
Cnr

PROJECT

ICT
Premium Booth
4mW x 3mD

DATE:

SHEET

SD-A02a