

For International ICT Expo ONLY

Premium Booth 4mW x 3mD One side open

SD-C-12
4mW x 3mD x 3.5mH

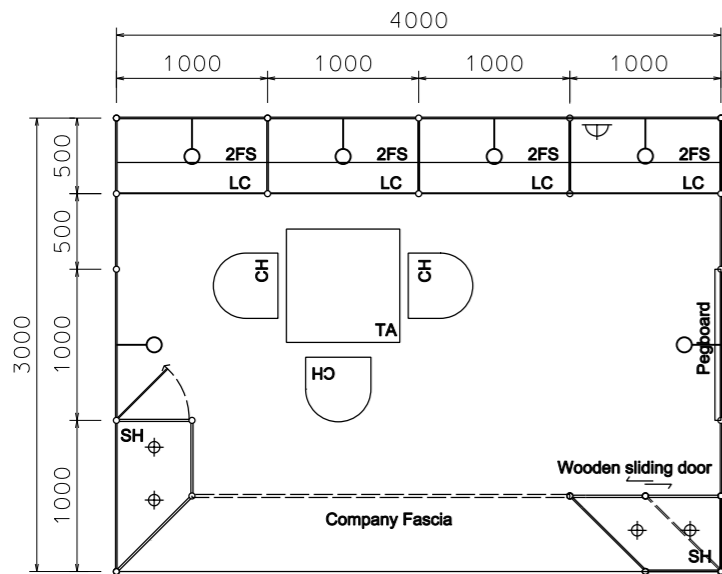

PLAN



PERSPECTIVE N.T.S

Company Fascia
Panel in colour laminate stickers
-Respect M-3176
-Respect M-3173
-company name letter in white

Panel in colour sticker lamination
-Respect M-3176

Glass showcase with white wooden sliding door
(1000mmW x 500mmD x 2500mmH)
with 2x 50W halogen downlight)

Plywd panel in colour sticker laminations
-Respect M-3176
-Respect M-3173

Glass showcase with white wooden swing door
(1000mmW x 500mmD x 2500mmH)
with 2x 50W halogen downlight)



COLOUR PERSPECTIVE N.T.S

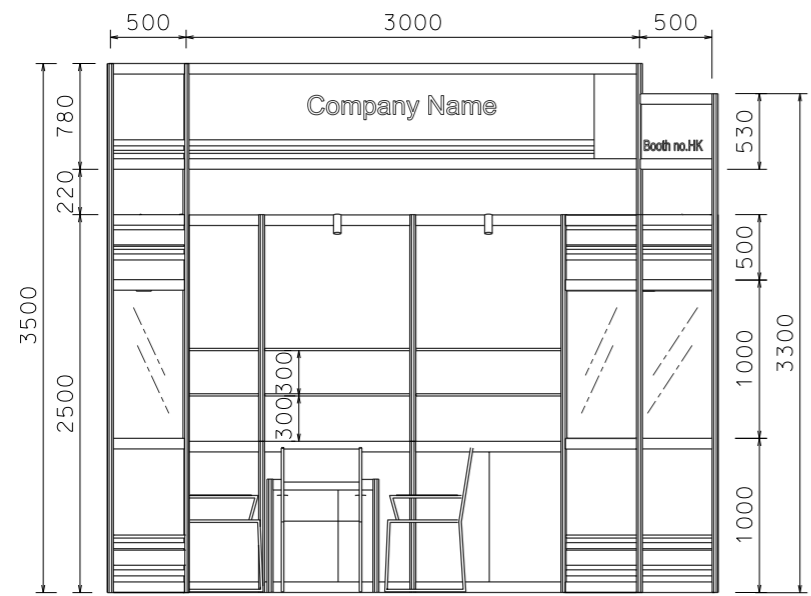

FRONT ELEVATION

BOOTH SPECIFICATION		QTY
	Front glass showcase in sticker lamination with white wooden swing door. 2 x (50W) halogen downlight (1m W x 0.5mD x 2.5m H)	1
	Front glass showcase in sticker lamination with white wooden sliding doors. 2 x (50W) halogen downlight (1m W x 0.5mD x 2.5m H)	1
	Lockable cabinet (1mL x 0.5mD x 1mH)	4
	Wooden shelf (flat) (1mL x 0.3mD)	8
	Pegboard with 30 hooks (1mW x 2.5mH)	1
	Square meeting table (0.7m X 0.7m x 0.75mH)	1
	Black leather chair	3
	Longarmed spotlight w/23 watt energy saving lamp (yellow)	6
	500w Square pin power socket	1

FILE PATH - L:\Local Fair Premium Booth 2011\ICT\SD-C layout\SD-C-2dLayout_update.dgn



NOTES UNLESS OTHERWISE SPECIFIED ALL DIMENSIONS ARE IN MM.

.....

.....

.....

REVISION

DATE: 18/09/2014

SCALE: 1 : 50 (A3)

DRAWN BY: ..

CHECKED BY:

TITLE

Premium Booth SD-C-12

PROJECT

ICT PREMIUM BOOTH 4m x 3m

DATE: XXXXXXXX

SHEET

SD-C02