

For International ICT ONLY

Premium Booth 6mW x 3mD One side open

SD-A-18
6mW x 3mD x 3.5mH

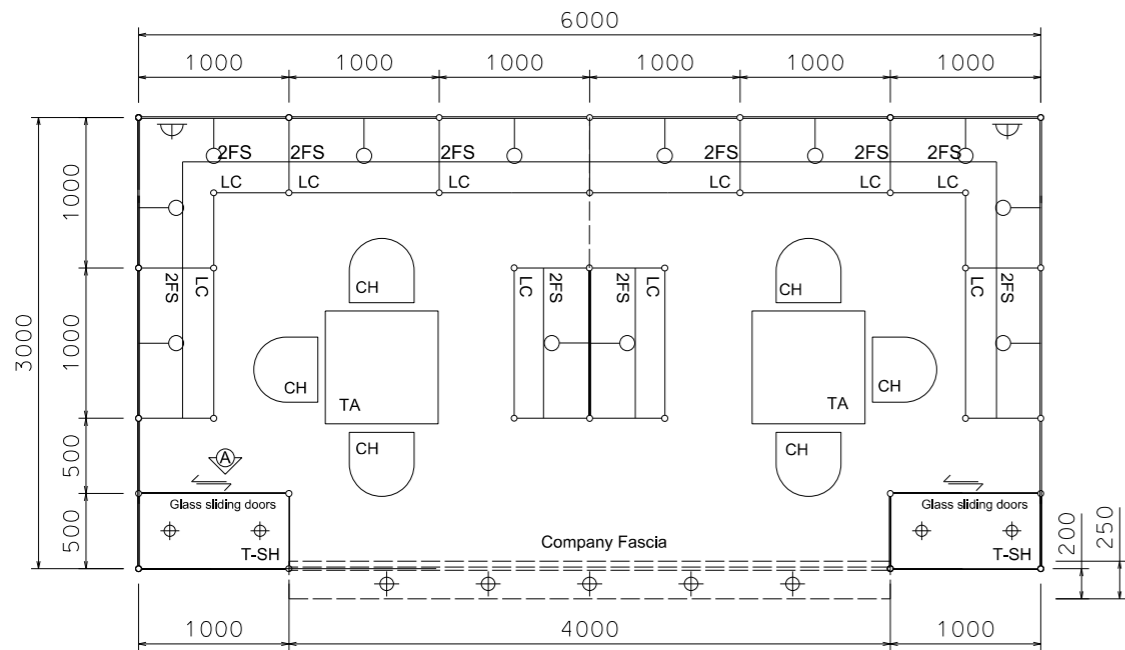

PLAN

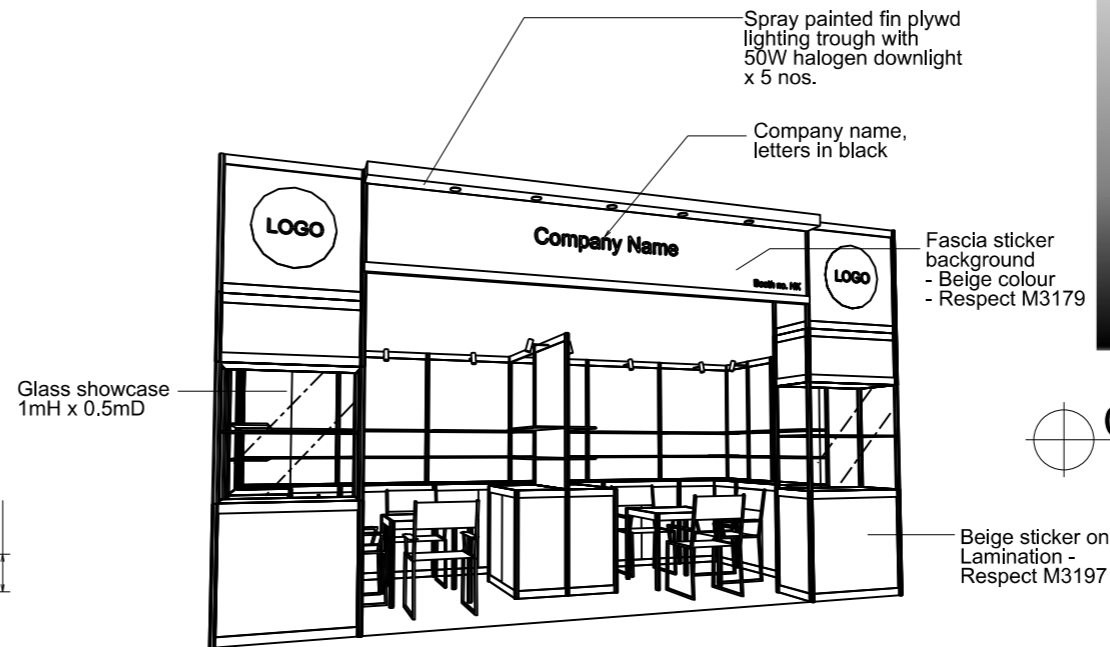

PERSPECTIVE N.T.S.



COLOUR PERSPECTIVE N.T.S

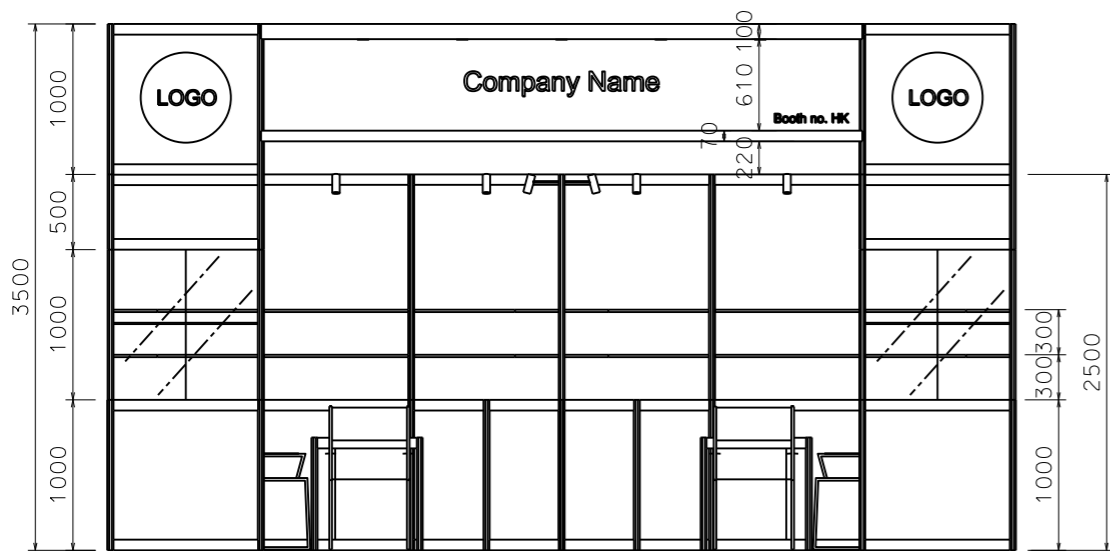

FRONT ELEVATION

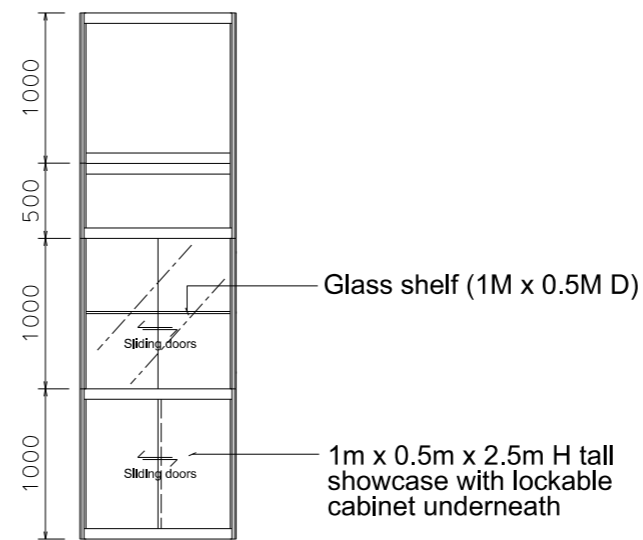

VIEW A

| BOOTH SPECIFICATION | | QTY |
|---------------------|--|-----|
| | Tall showcase in beige sticker lamination, 1 layer of glass shelf, 2x 50W halogen downlights | 2 |
| | Lockable cabinet in beige sticker lamination (1mL x 0.5mD x 1mH) | 11 |
| | Wooden shelf (flat) (1mL x 0.3mD) | 24 |
| | Square meeting table (0.7m X 0.7m x 0.75mH) | 2 |
| | Black leather chair | 6 |
| | Longarmed spotlight w/23 watt energy saving lamp (yellow) | 12 |
| | 50W Halogen light (for fascia) | 5 |
| | 500w Square pin power socket | 2 |
| | Company Logo | 2 |

FILE PATH - L:\Local Fair Premium Booth 2011\ICT\SD-A layout\SD-A-Layout-ICT_update.dgn



NOTES UNLESS OTHERWISE SPECIFIED ALL DIMENSIONS ARE IN MM.

.....
.....
.....

REVISION

DATE: 12/09/2014
SCALE: 1 : 50 (A3)
DRAWN BY: ..
CHECKED BY:

TITLE

Premium Booth
SD-A-18

PROJECT

ICT
Premium Booth
6mW x 3mD

DATE:

SHEET

SD-A03