

For International ICT Expo ONLY

Premium Booth 3mW x 3mD One side open

SD-A-9
3mW x 3mD x 3.5mH

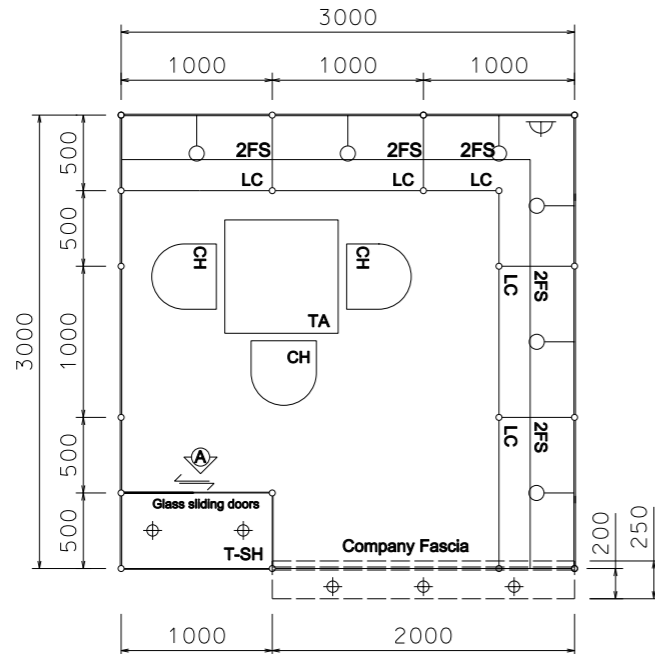

PLAN

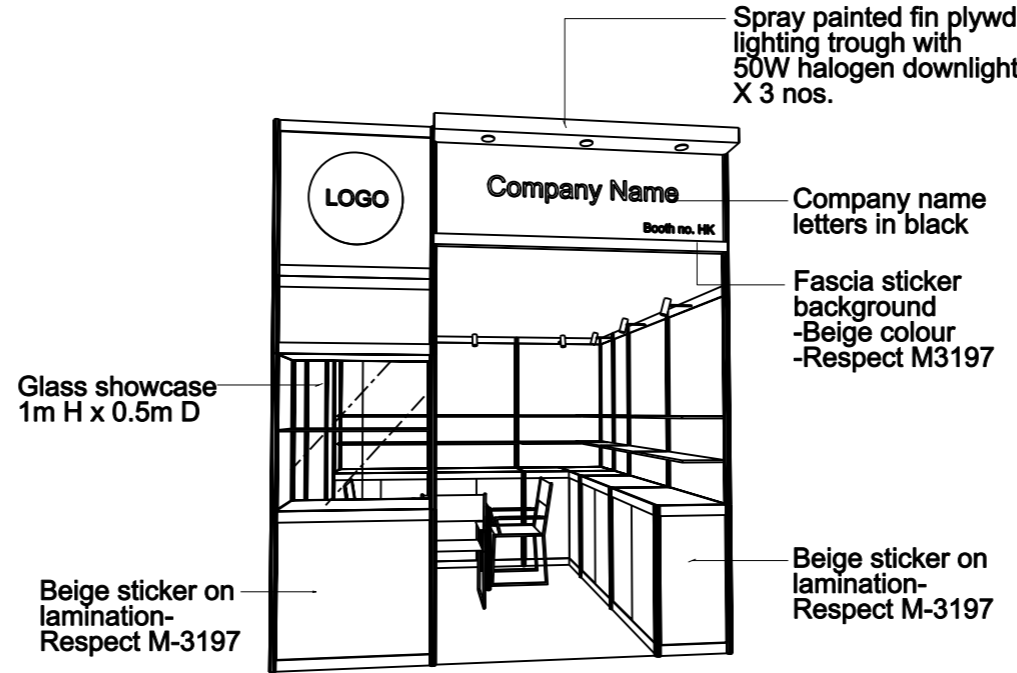

PERSPECTIVE N.T.S



COLOUR PERSPECTIVE N.T.S

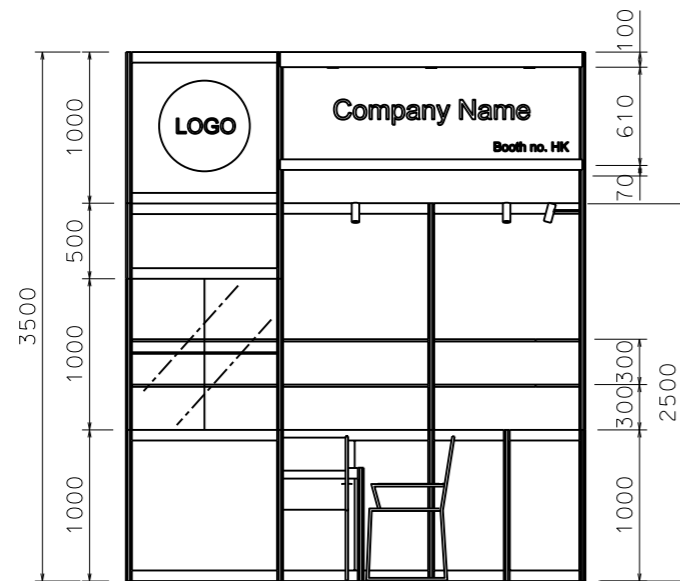

FRONT ELEVATION

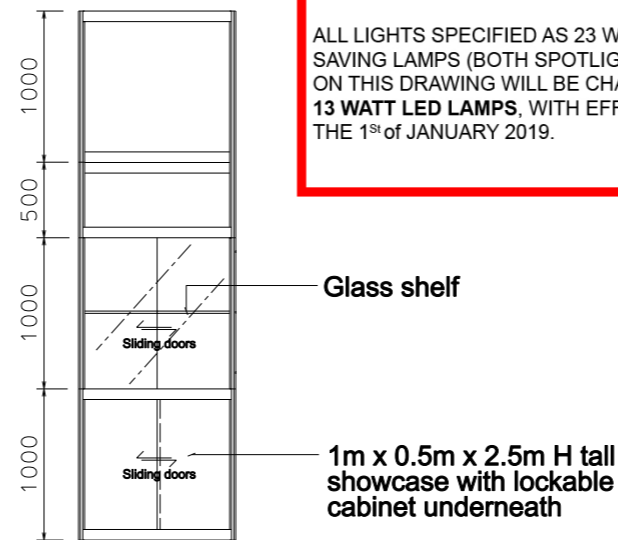

VIEW A

IMPORTANT NOTICE
AMENDMENT OF BOOTH LIGHTING SPECIFICATIONS

ALL LIGHTS SPECIFIED AS 23 WATT ENERGY SAVING LAMPS (BOTH SPOTLIGHT/LONGARMED) ON THIS DRAWING WILL BE CHANGED TO 13 WATT LED LAMPS, WITH EFFECT ON THE 1ST of JANUARY 2019.

BOOTH SPECIFICATION		QTY
	Tall showcase in beige sticker lamination, 1 layer of glass shelf, 2x 50W halogen downlights	1
	Lockable cabinet in beige sticker lamination (1mL x 0.5mD x 1mH)	5.5
	Wooden shelf (flat) (1mL x 0.3mD)	12
	Square meeting table (0.7m X0.7m x 0.75mH)	1
	Black leather chair	3
	Longarmed spotlight w/23 watt energy saving lamp (yellow)	6
	50W Halogen light (for fascia)	3
	500w Square pin power socket	1
	Company Logo	1

FILE PATH - L:\Local Fair Premium Booth 2011\ICT\SD-A layout\SD-A-Layout\CT_update.dgn



NOTES UNLESS OTHERWISE SPECIFIED ALL DIMENSIONS ARE IN MM.

.....
.....
.....

.....
.....
.....

REVISION

DATE:	12/09/2014
SCALE:	1 : 50 (A3)
DRAWN BY:	..
CHECKED BY:

TITLE

Premium Booth SD-A-9

PROJECT

ICT PREMIUM BOOTH 3m x 3m

DATE: XXXXXXXX

SHEET

SD-A01