

For International ICT ONLY

Premium Booth 3mW x 3mD Left corner booth

SD-A-9-L Cnr
3mW x 3mD x 3.5mH

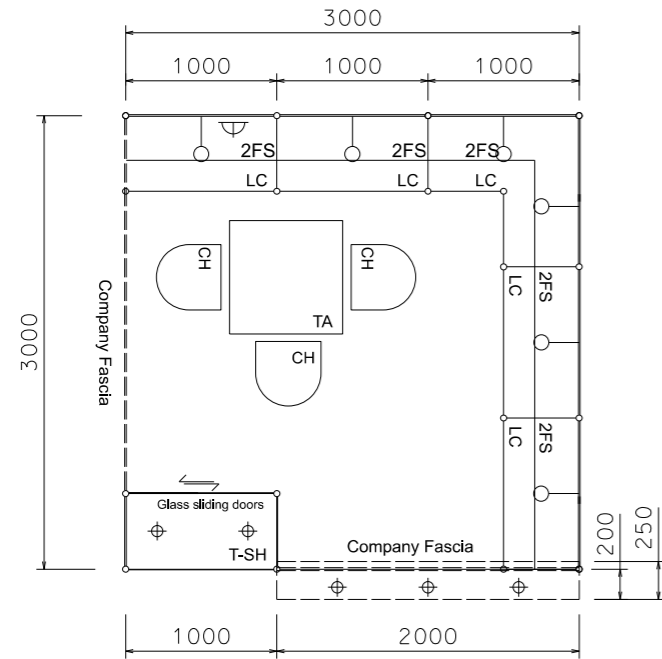

PLAN



PERSPECTIVE N.T.S.



COLOUR PERSPECTIVE N.T.S.

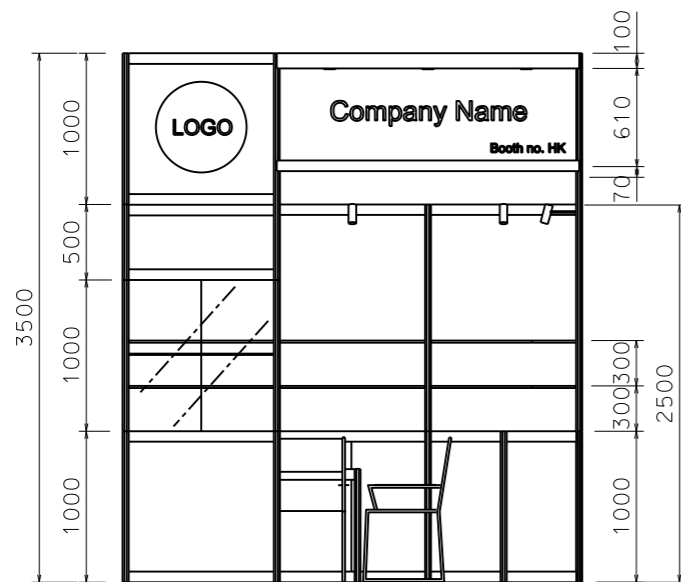

FRONT ELEVATION

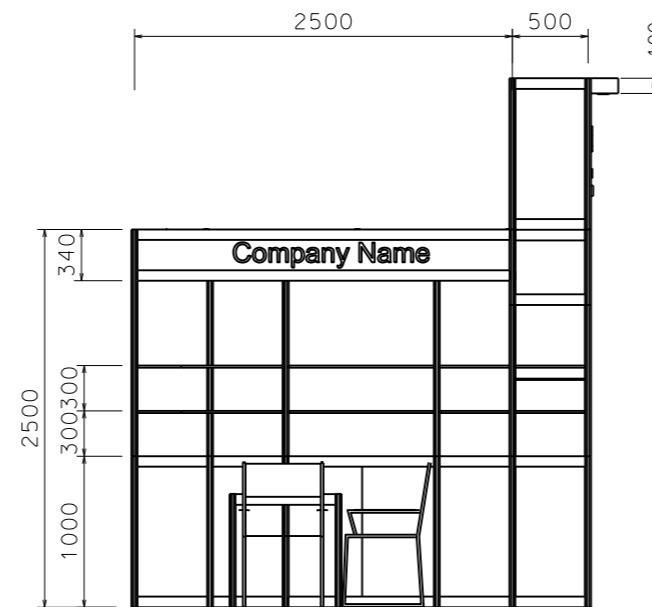

LEFT ELEVATION

BOOTH SPECIFICATION		QTY
	Tall showcase in beige sticker lamination, 1 layer of glass shelf, 2x 50W halogen downlights 高身陳列飾櫃連一層玻璃層板及兩盞50瓦特鹵素射燈	1
	Lockable cabinet in beige sticker lamination (1mL x 0.5mD x 1mH) 儲物櫃	5.5
	Wooden shelf (flat) (1mL x 0.3mD) 陳列架	12
	Square meeting table (0.7m X 0.7m x 0.75mH) 正方檯	1
	Black leather chair 椅子	3
	Longarmed spotlight w/13 watt LED lamp (yellow) 13瓦特led燈膽短臂射燈 (黃光)	6
	50W Halogen light (for fascia) 50瓦特鹵素射燈	3
	500w Square pin power socket 插座	1
	Company Logo 公司商標	1

Glass showcase
1mH x 0.5mD
高身陳列飾櫃

Beige sticker on Lamination - Respect M3197
高身陳列飾櫃

Spray painted fin plywd lighting trough with 50W halogen downlight x 3 nos.
燈槽連50瓦特鹵素射燈

Company name, letters in black
公司招牌板貼紙裝飾

Fascia sticker background - Beige colour - Respect M3179
公司招牌板貼紙裝飾

Beige sticker on Lamination - Respect M3197
地櫃連貼紙裝飾

FILE PATH - L:\Local Fair Premium Booth 2011\ICT\SD-A layout\SD-A-Layout ICT_update.dgn



NOTES UNLESS OTHERWISE SPECIFIED ALL DIMENSIONS ARE IN MM.

.....
.....
.....

.....
.....
.....

REVISION
12-09-2014
07-08-2020
11-08-2020

DATE: 11-08-2020
SCALE: 1 : 50 (A3)
DRAWN BY: ..
CHECKED BY:

TITLE
Premium Booth
SD-A-9-L
Cnr

PROJECT
ICT
Premium Booth
3mW x 3mD
DATE:

SHEET
SD-A01a