

For International ICT Expo ONLY

Premium Booth 3mW x 3mD One side open

SD-C-9
3mW x 3mD x 3.5mH

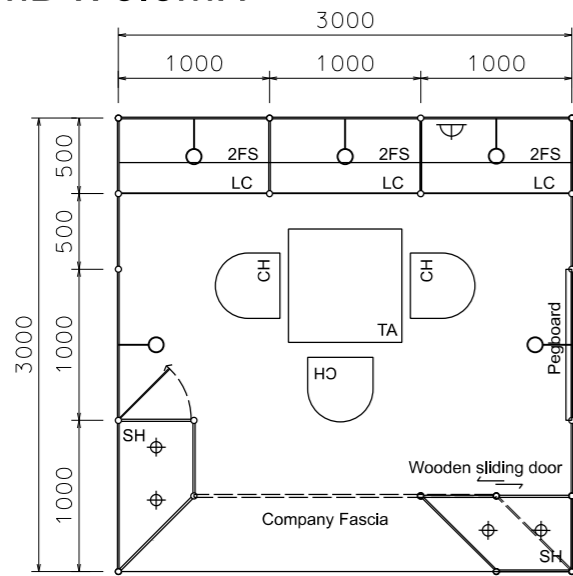

PLAN

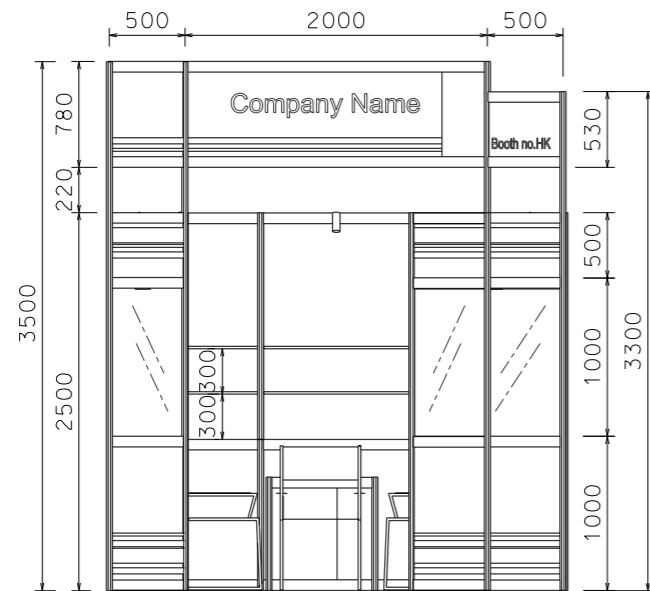

FRONT ELEVATION

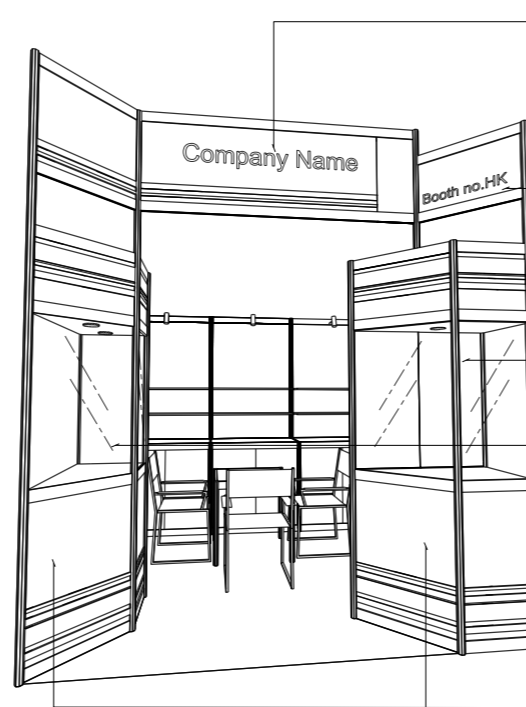

PERSPECTIVE N.T.S

Company Fascia
Panel in colour laminate stickers
-Respect M-3176
-Respect M-3173
-company name letters in white
公司招牌板貼紙裝飾

Panel in colour sticker lamination
-Respect M-3176
貼紙裝飾

Glass showcase with
white wooden sliding door
(1000mmW x 500mmD x 2500mmH)
with 2x 50W halogen downlight)
高身陳列飾櫃連50瓦特鹵素射燈

Glass showcase with
white wooden swing door
(1000mmW x 500mmD x 2500mmH)
with 2x 50W halogen downlight)
高身陳列飾櫃連50瓦特鹵素射燈

Plywd panel in colour
sticker laminations
-Respect M-3176
-Respect M-3173
貼紙裝飾



COLOUR PERSPECTIVE N.T.S

BOOTH SPECIFICATION		QTY
	Front glass showcase in sticker lamination with white wooden sliding door. 2 x (50W) halogen downlight (1m W x 0.5mD x 2.5m H) 高身陳列飾櫃連兩盞50瓦特鹵素射燈	1
	Front glass showcase in sticker lamination with white wooden sliding doors. 2 x (50W) halogen downlight (1m W x 0.5mD x 2.5m H) 高身陳列飾櫃連兩盞50瓦特鹵素射燈	1
	Lockable cabinet (1mL x 0.5mD x 1mH) 儲物櫃	3
	Wooden shelf (flat) (1mL x 0.3mD) 陳列架	6
	Pegboard with 30 hooks (1mW x 2.5mH) 有孔陳列板連30個掛鉤	1
	Square meeting table (0.7m X 0.7m x 0.75mH) 正方檯	1
	Black leather chair 椅子	3
	Longarmed spotlight w/13 watt LED lamp (yellow) 13瓦特led燈膽短臂射燈 (黃光)	5
	500w Square pin power socket 插座	1

FILE PATH - L:\Local Fair Premium Booth 2011\ICT\SD-C layout\SD-C-2d\Layout_update.dgn



NOTES UNLESS OTHERWISE SPECIFIED ALL DIMENSIONS ARE IN MM.

.....
.....
.....

.....
.....
.....

REVISION
18-09-2014
07-08-2020

DATE: 07-08-2020
SCALE: 1 : 50 (A3)
DRAWN BY: ..
CHECKED BY:

TITLE
Premium Booth SD-C-9

PROJECT
ICT PREMIUM BOOTH
3m x 3m
DATE: XXXXXXXX

SHEET
SD-C01